

- Passo de 5mm
- Modulares - Possuem encaixes que permitem a combinação de diversos blocos
- Produzidos com material anti-chama
- 5mm pitch
- Modular - Allow combinations of blocks
- Produced with non flammable material

Código de compra / How to order

BR402V

Vias / Ways
2 ou/or 3

Cor / Color
V - Verde / Green
P - Preto / Black



Especificações / Specifications

	UL	IEC
Tensão nominal / Rated voltage	300V	250V
Corrente nominal / Current rating	16A	20A
Cabo aplicável / Applicable wire	22 ~ 14AWG	0,5 ~ 2,5mm ²
Resistência de contato / Contact resistance	20mΩ	
Resistência de isolamento / Insulation resistance	500MΩ (1000VCC/MDC)	
Rigidez dielétrica / Withstanding voltage	2000 VCA/VAC (1 minuto/minute)	
Temperatura de operação / Temperature range	-40°C ~ +105°C	
Torque máximo / Maximum torque	0,4Nm (3.6Lb.in)	
Alojamento / Housing	PA66, UL94V-0	
Parafuso / Screw	Aço M2,5 - Zincado / M2.5 steel - Zinc plated	
Terminais / Terminals	Latão estanhado / Brass tin finished	
Contato / Contact	Latão niquelado / Brass nickel plated	
Cores / Colors	Verde ou preto / Green or black	

Dimensões / Dimensions

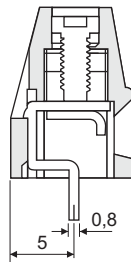
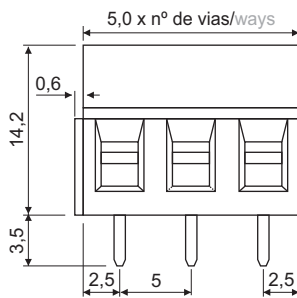

Furação PCI / PCB layout

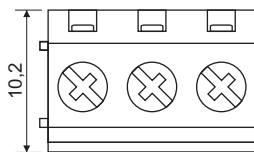
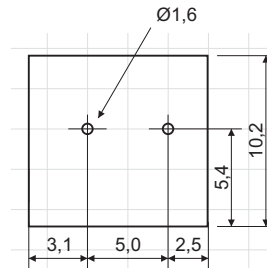

Tolerâncias / Tolerance : ± 0,20 mm

Todas as dimensões em milímetros / All dimensions in millimeters